

Whychus Canyon Preserve - Trail Map

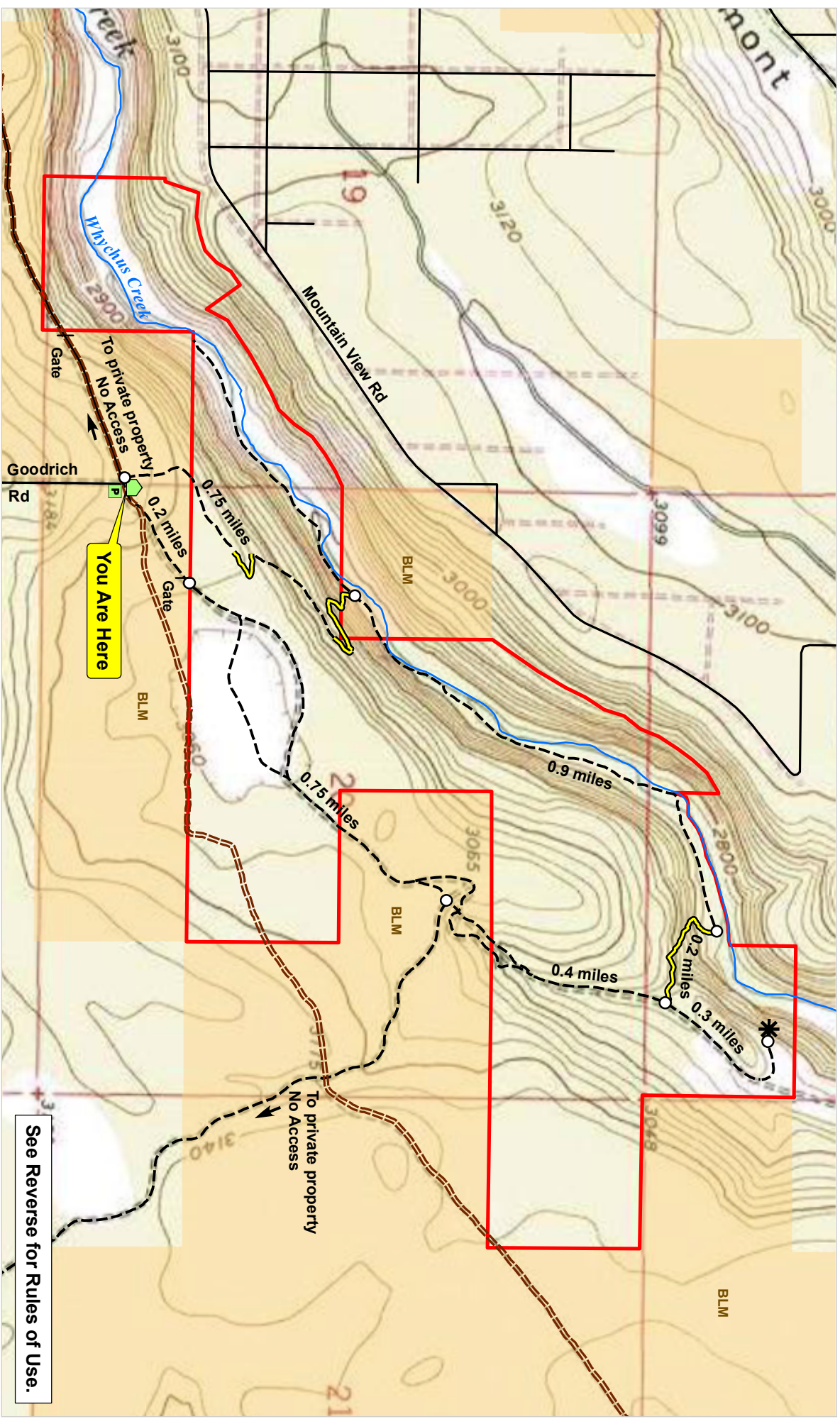

Source:
2009 NAPP 0.5 m aerial
Deschutes County GIS data

Map by D. Quinlan, 5/24/11
trail_map/11x17_whyhcan_aerial_
trails_kiosk.mxd

- Whychus Canyon Preserve
- BLM ownership
- Temporary Kiosk and Parking
- Existing road / trail
- Temporary flagged hiking trail routes
- Cascade military wagon road
- ~ Whychus Creek
- Street
- * Scenic overlook

NOTE: Motorized vehicle use is prohibited within Preserve boundaries.

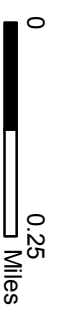
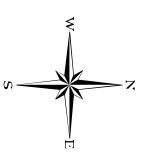

See Reverse for Rules of Use.



WHYCHUS CANYON PRESERVE



Photo: Deb Quinlan.

Whychus Canyon Preserve is open to the public during daylight hours, year-round. We encourage you to explore this beautiful 450 acre property that protects 2 miles of Whychus Creek and outstanding habitat for fish and wildlife. While doing so, please observe our Preserve Etiquette:

- **Enjoy the trail by foot (please no bikes, motorized vehicles, or horses).**
- **To protect sensitive soils, please stay on roads and trails.**
- **Leave No Trace: Please leave the Preserve as you found it. Take only photographs and leave only footprints.**
- **Dogs permitted on leash.**
- **No camping, campfires, or smoking.**
- **Catch and release flyfishing with barbless hooks is permitted; hunting is not permitted.**

With trail development still in progress, please be aware that temporary, flagged trails may not be clearly marked. You may also encounter rattlesnakes, steep canyon walls, and uneven terrain. Proceed with caution at your own risk.

WHYCHUS CANYON PRESERVE: PLANS FOR THE FUTURE

Many thanks to the individuals, agencies, and foundations that helped the Deschutes Land Trust purchase and protect Whychus Canyon Preserve at the end of 2010! Now that the Land Trust owns the Preserve we can begin implementing our stewardship and restoration plans. At Whychus Canyon Preserve our primary goals are to protect and restore fish and wildlife habitat; while providing for public interpretation, education, and low-impact recreation.

Though major restoration projects still await funding, our focus is on restoring the native forests and meadows of Whychus Canyon Preserve. The Preserve contains a diverse mix of plant communities including quaking aspens, old-growth junipers, sagebrush meadows, and ponderosa pine stands. To restore ponderosa pine and aspen stands we'll thin juniper and remove invasive weeds from the Preserve.

In addition to restoration work, trail development is a priority. We are currently working to develop trail routes and access plans that will include access to Whychus Creek and potentially one day link trails on the Preserve with nearby trails to Alder Springs and the adjacent National Grasslands.

Future restoration and interpretive plans include restoring the stream as needed, building permanent interpretive kiosks, and enhancing trails and overlooks with benches and signs. These projects will proceed as funds are secured.

To get involved with the stewardship of this Preserve, please contact the Land Trust: (541) 330-0017 or www.deschuteslandtrust.org